

PROJECT MANAGER *James C. Zeller, P.E.*, 703-259-3220, VDOT, Northern Virginia District
 SURVEYED BY *Rice Associates*, 703-968-3200, Manassas, Va.
 DESIGN SUPERVISED BY *Lochner*, 919-571-7111, Raleigh, NC
 DESIGNED BY *Lochner*, 919-571-7111, Raleigh, NC

THE PLAINS ROAD INTERSECTION DETAIL

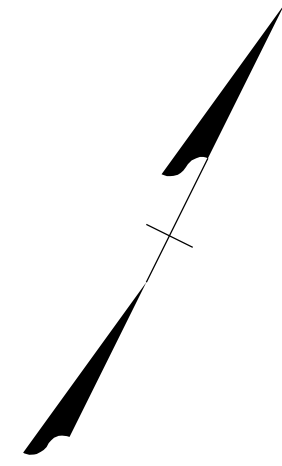

COMMONWEALTH OF VIRGINIA
 BRIAN K. EASON
 No. 046232
 PROFESSIONAL ENGINEER

H.W. Lochner Inc.
 Raleigh, North Carolina
 ROADWAY ENGINEER

REVISED	STATE	ROUTE	STATE PROJECT	SHEET NO.
	VA.	50	0050-259-241, RW-201 C-501	2C(1)

DESIGN FEATURES RELATING TO CONSTRUCTION OR TO REGULATION AND CONTROL OF TRAFFIC MAY BE SUBJECT TO CHANGE AS DEEMED NECESSARY BY THE DEPARTMENT

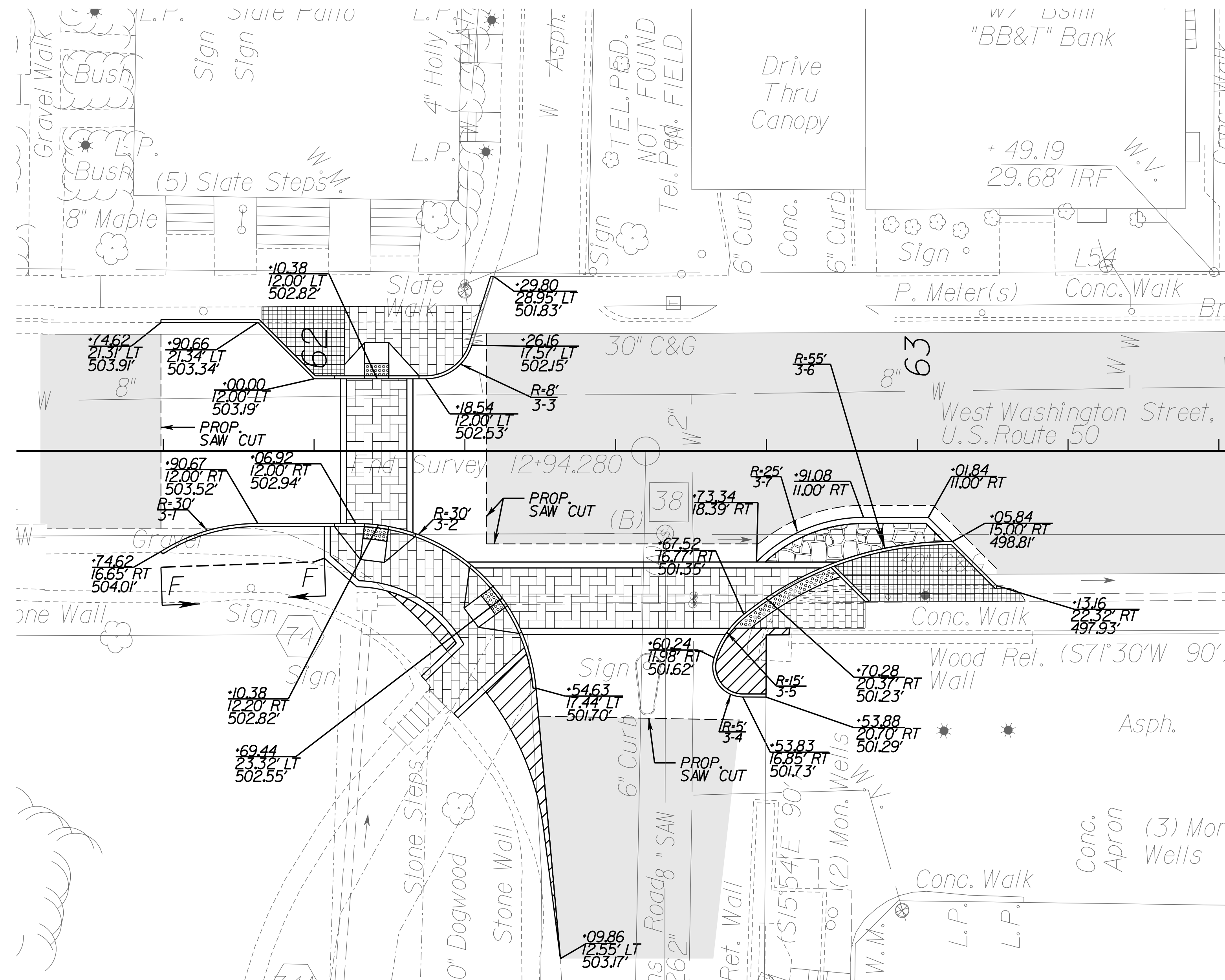

- Legend**
- ☆ CONTRACTOR TO COORDINATE WITH DOMINION POWER TO REMOVE POWER POLE
 - ⊠ ROTATE CONE OF MANHOLE
 - MIN. 1.5" MILL & REPLACE WITH SM-9.5D

NOTE: CURB RAMPS SHALL PROVIDE POSITIVE DRAINAGE AWAY FROM EXISTING BUILDINGS

REFERENCES (PROFILES & SHEETS)

Mainline Planview	3
Mainline Profile	3A
Landscape Plans	10(3-1)

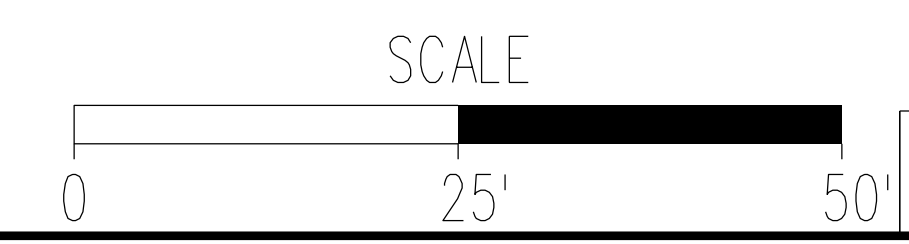

PROJECT	SHEET NO.
0050-259-241	2C(1)