

PROJECT MANAGER WAYNE E. LIGHTFOOT, (703) 259-3223
 SURVEYED BY LEON E. TREUTLE, L.S., (703) 259-3224
 DESIGN SUPERVISED BY JOSHUA S. WADE, P.E., (703) 352-7188
 DESIGNED BY PARSONS TRANSPORTATION GROUP, INC. (703) 934-2300

UTILITY OWNERS	
1	Washington Gas 6801 Industrial Road Springfield, Va. 22151 Phone: (703) 750-1000
2	Verizon Field Contact: Deam Rasmussen Phone: (434) 942-8192
3	Comcast 5401 Staples Mill Road Richmond, Va. 23228 Phone: (804) 915-5370
4	Dominion Virginia Power 701 E. Cary St. Richmond, VA Andrew Brooks Underground Damage Prevention Manager Dominion Emergency Preparedness Center (804) 771 - 3655 (804) 514 - 2277 cell Andrew.Brooks@dom.com

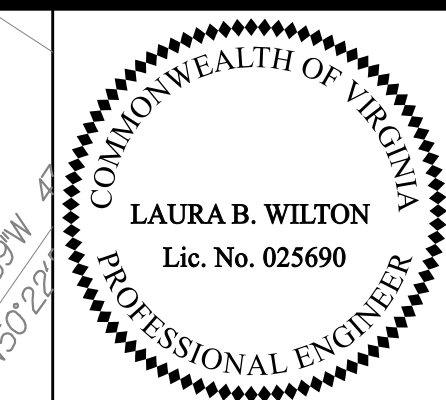

Parsons Transportation
 Group Inc. of Virginia
 Fairfax, Virginia
 ROADWAY & HYDRAULIC
 ENGINEER

JED INC
 DB751 PG533
 0.4686 AC.
 Tax# 8191-68-5566

JED INC
 DB751 PG533
 0.8849 AC.
 Tax# 8191-68-9452

REVISED	STATE	ROUTE	STATE	PROJECT	SHEET NO.
	VA.	784		078-076-049, PE-101, M-501	4

DESIGN FEATURES RELATING TO CONSTRUCTION OR TO REGULATION AND CONTROL OF TRAFFIC MAY BE SUBJECT TO CHANGE AS DEEMED NECESSARY BY THE DEPARTMENT

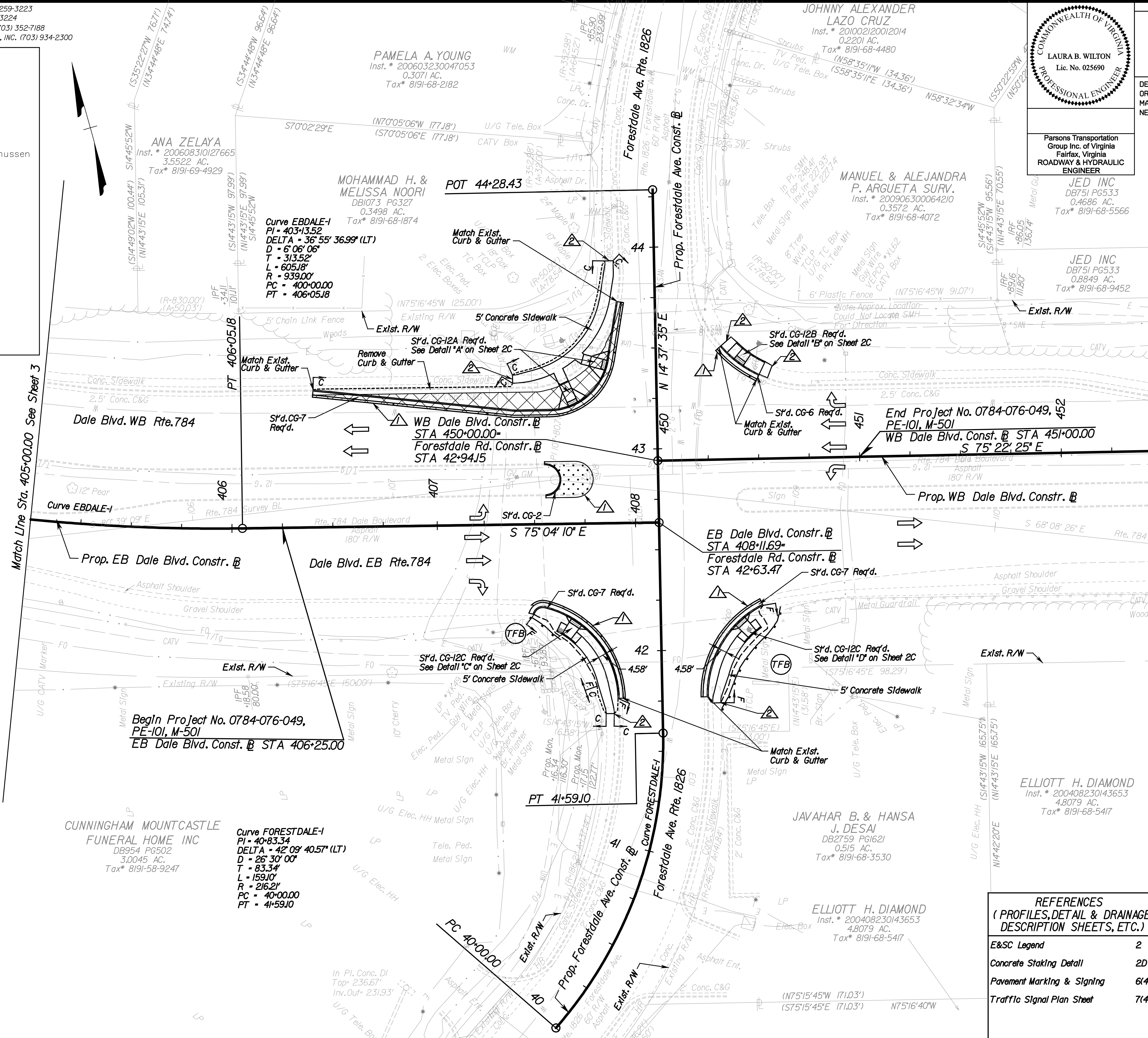

- NOTES:**
- ▲ Full Depth Vertical Sawcut
 - ▲ Sawcut Sidewalk at Nearest Joint.
- LEGEND**
- *Note: Dot-dot-dashed lines denote temporary easements.*
 - *Note: Dot-dashed lines denote permanent easements.*
 - *Note: Dashed lines denote utility easements.*

- ☐ Denotes Construction Limits In Cuts
- ☐ Denotes Construction Limits In Fills
- ☐ Denotes Demolition of Pavement
- ☐ Denotes Planing and Resurfacing of Pavement
- ☐ Denotes Full Depth Pavement
- ➔ Lane Use Arrows
- ➔ Exlst. Lane Use Arrows

REFERENCES
 (PROFILES, DETAIL & DRAINAGE DESCRIPTION SHEETS, ETC.)

E&S Legend	2
Concrete Staking Detail	2D
Pavement Marking & Signing	6(4)
Traffic Signal Plan Sheet	7(4)

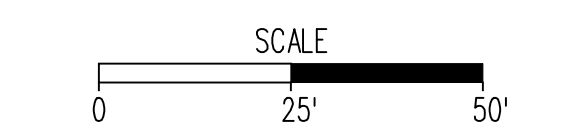

PROJECT	SHEET NO.
078-076-049	4

Tuesday, April 09, 2013 12:40:57 PM